



MILES ESTATE AGENTS

**3 Belle Vue Terrace Fons George Fons George,
Taunton**



A substantial Victorian 3 storey townhouse, pleasantly situated close to Vivary park with 3 double bedrooms (including full loft conversion) spacious sitting room and large kitchen/dining room, within Castle catchment area. Enclosed garden and resident permit parking - some scope for improvement but immediately available with NO ONWARD CHAIN. Early viewing recommended. Freehold Council Tax Band C EPC : D





Features:

- Long entrance hall
- Spacious sitting room with fireplace, built in cabinets & sash windows
- Kitchen/dining room with french windows to garden
- 2 double bedrooms to first floor
- Family bathroom
- Separate WC
- Further double bedroom to second floor with en suite cloakroom
- Enclosed south east facing garden
- Resident permit parking
- NO ONWARD CHAIN
- Freehold
- Council Tax Band C
- EPC : D



Denotes restricted head height

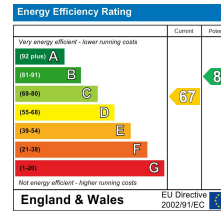
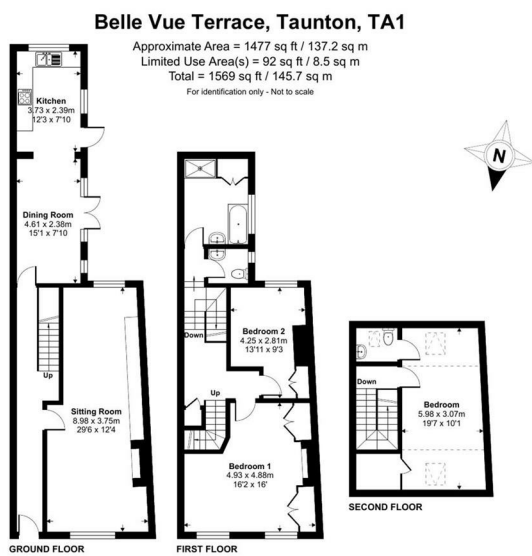

Floor plan produced in accordance with RICS Property Measurement 2nd Edition, incorporating International Property Measurement Standards (IPMS2 Residential). Produced for Miles Alexander Limited T/A Miles Estate Agents. REF: 1225764. © ricscom 2025.



Viewings strictly through the selling agents:

Miles Estate Agents

2 Piffin Lane, Bishops Lydeard, Taunton, Somerset, TA4 3AS

Tel: 01823 470 500

lydeard@milesestateagents.co.uk

www.milesestateagents.co.uk

rightmove

OnTheMarket.com

MILES ESTATE AGENTS

BEST
 ESTATE AGENT GUIDE
 2019 : EXCEPTIONAL
 SALES